

This drawing should not be scaled.
 All dimensions must be checked on site and contractor to report any omissions or errors to the contract administrator

17/2007

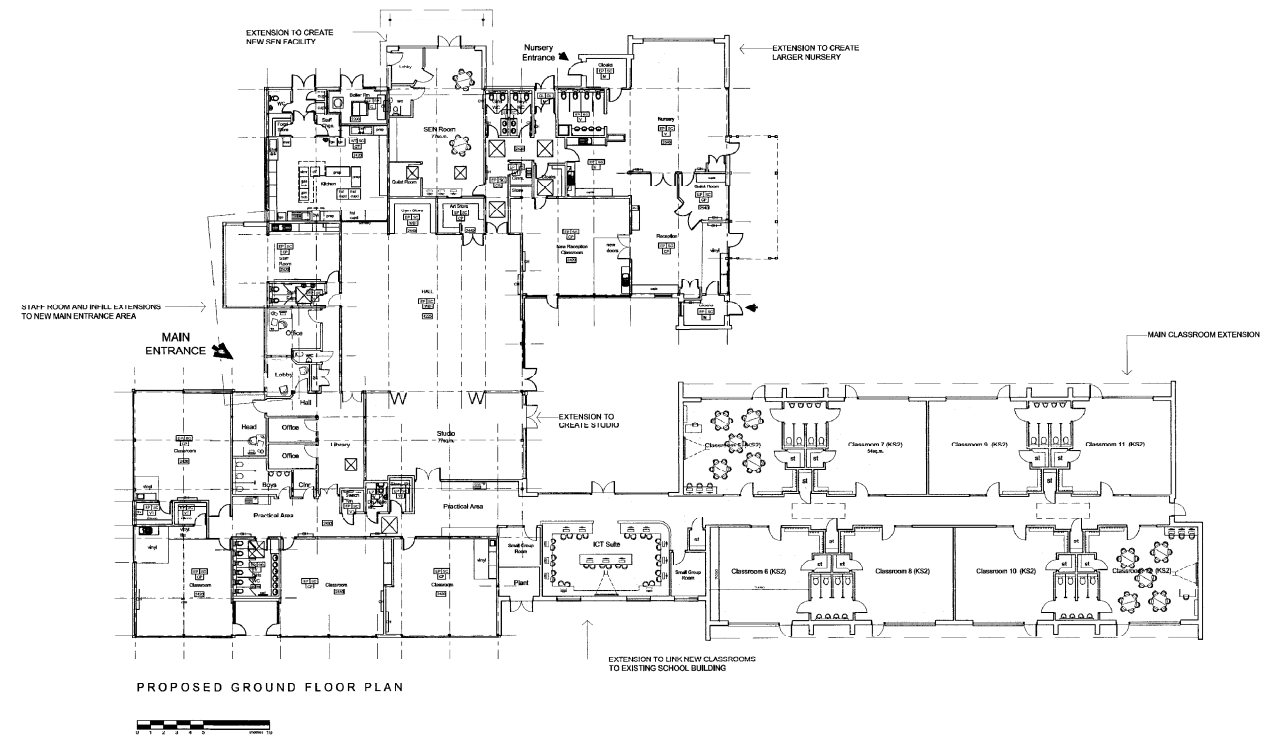

PROPOSED GROUND FLOOR PLAN

STOCKTON BOROUGH COUNCIL
 PLANNING
 -7 DEC 2012
 DATE RECEIVED

B Scale amended from 1:150 to 1:200 07.12.12
 A Issued for Planning Application 30.11.12

Rev	Description	On	Chk	Date

Drawing Status: PRELIMINARY APPROVAL
 INFORMATION TENDER CONSTRUCTION



Development & Neighbourhood Services
 Head of Technical Services Richard McCookin B.Eng., C.Eng., M.I.C.E.
 17 Old Box 228, Kingsway House, West Precinct, Ellingham, TS22 2YL
 Telephone (01642) 355939. E-mail: technicalservices@stockton.gov.uk

Project
 Junction Farm Primary School
 Extensions & Internal Alterations

Content
 PROPOSED FLOOR PLAN

Drawn	Checked	Scale	Rev
jcs	mds	1:200	B

Usage: Nov. 2012 Arc No. ARC1224 - 104
 Drawing No. 1:200